

SCALE

SECTION THRU KEEL

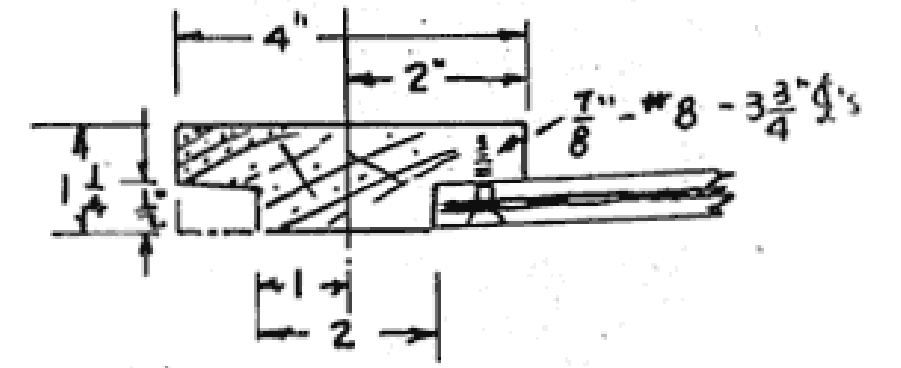

Bow dimensions are closely approximate.
Lay in, fair with batten, & flatter as needed.

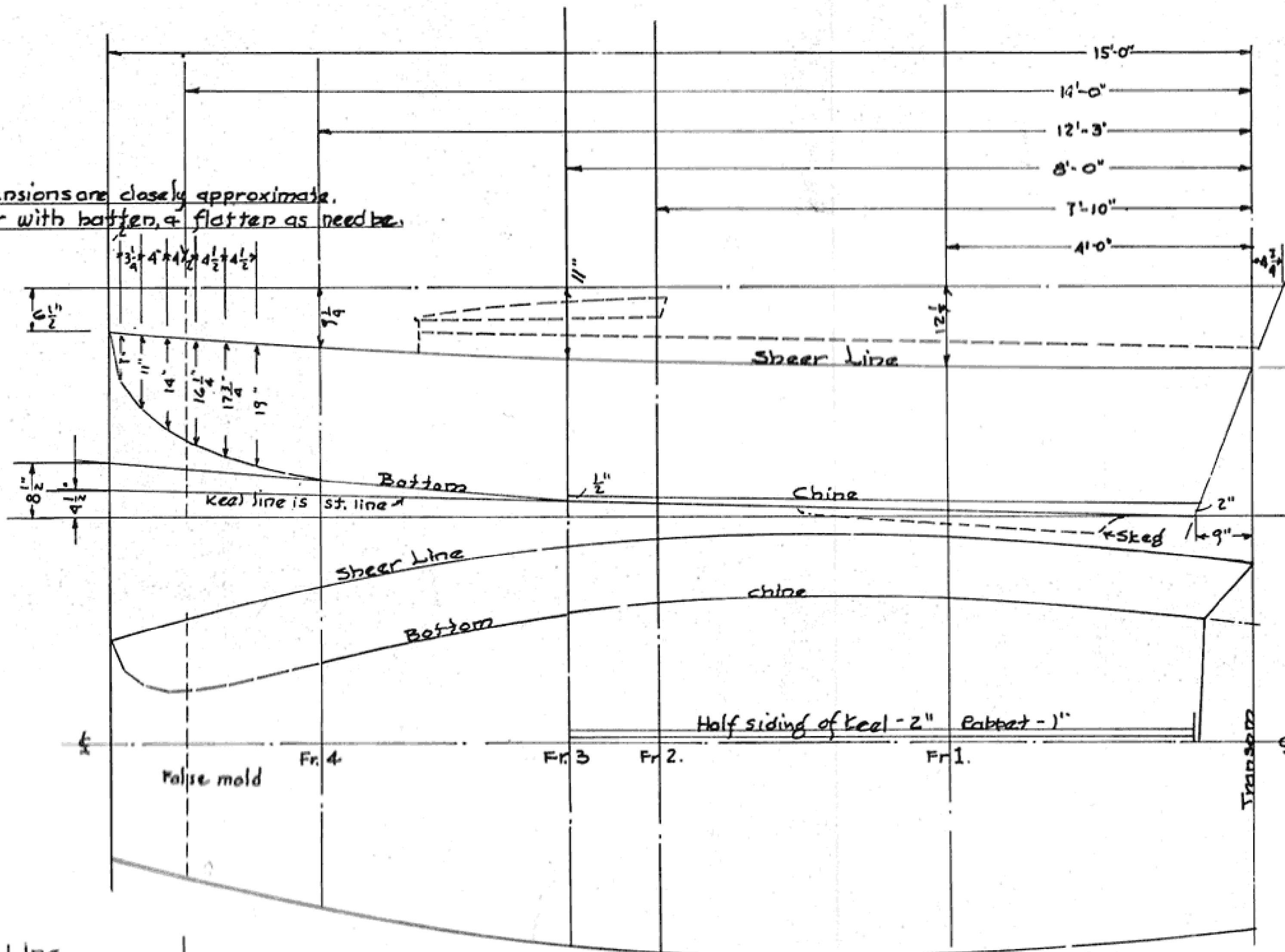

If you measure off planking here, result will be cut on dotted line, which is wrong method and gives 'fat' frames. Use compass as shown.

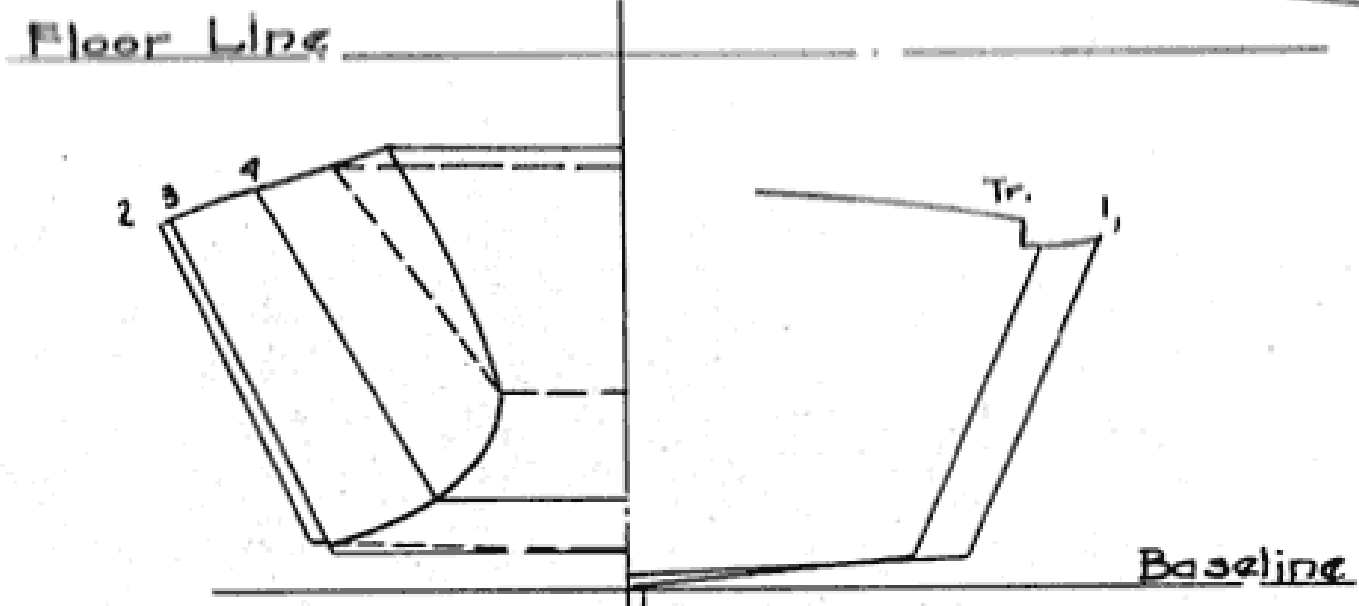
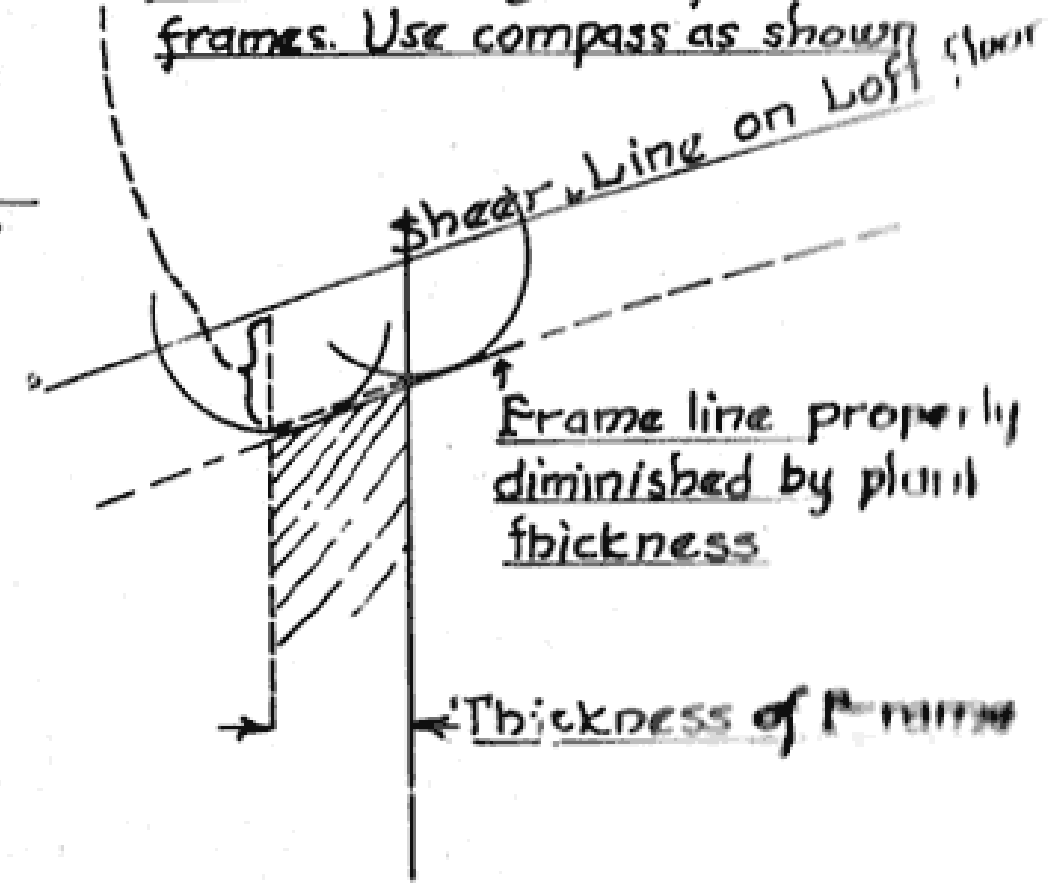

Forward bottom on Fr. 3 is flat. Aft bottom has deadrise of 1/2" in rabbeted fashion piece

Heights above Baseline	Tran.	Fr. 1	Fr. 2	Fr. 3	Fr. 4	F. Mold	
	2"	2 1/2"	3"	3 1/4" ±	5 1/2" +	11 3/4"	Chine
	0"	St. Line to 4 1/2" fwd.					Keel
1/2 Brdth from 1/2	27 1/2"	31 7/8"	31 1/2"	30 1/2"	24 3/8"	19 1/2"	Sheer
	19 1/2"	22 1/2"	21 3/4"	20"	12 1/2"	8 1/2"	Chine

All dimensions in inches

LINES, OFFSETS & BODY PLAN for "WANIGAN"

Use this scale to find dimensions in doubt:

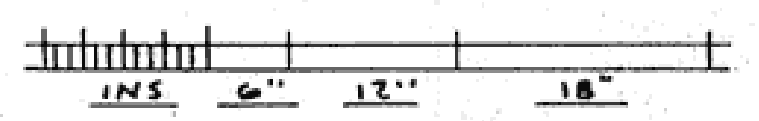

Cuddy top of veneer or 1/8" layered fiberglass swings up to position shown. Plastic spray hood forms cabin over 1/8" stranded cable.

1/4" Bolts thru here hold whole top locked vertically

Tiller springs hold 1/8" cable

Foredeck 2 layers 1/4" ply

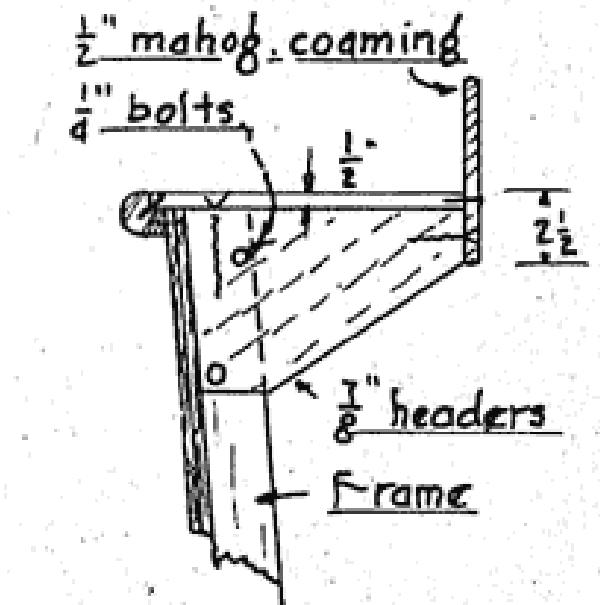

SCHEME OF COAMING, CLOSED BOAT

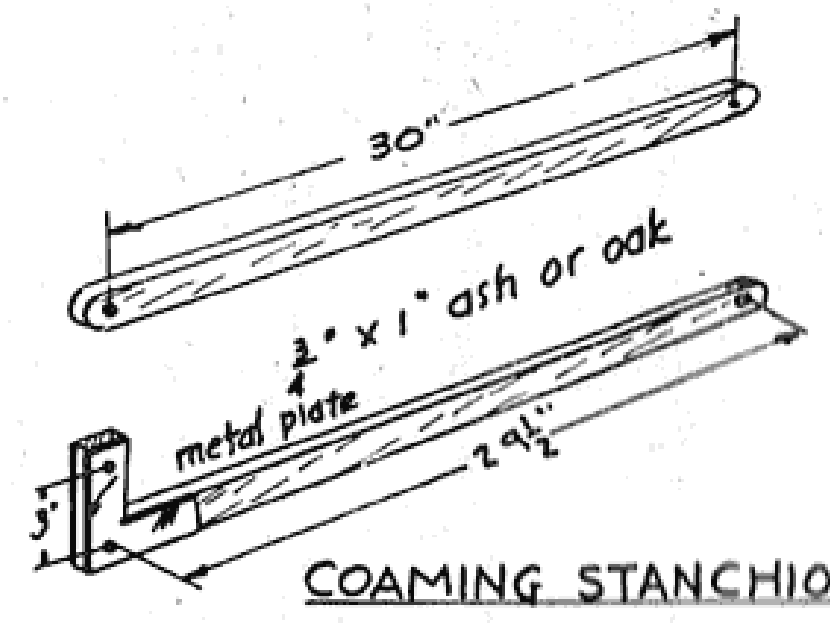

COAMING STANCHIONS

PLANK FITS AT BOW

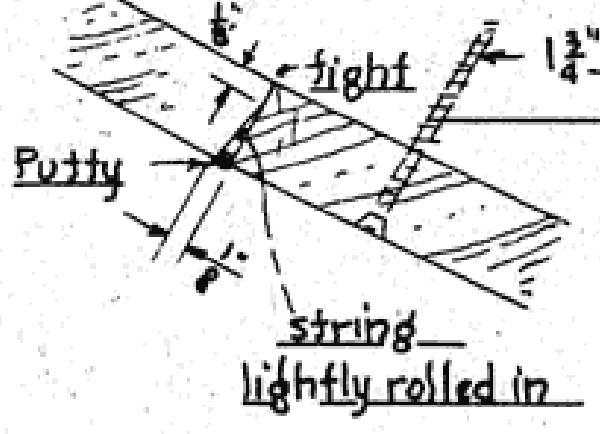

Top of seat riser is 16" above baseline

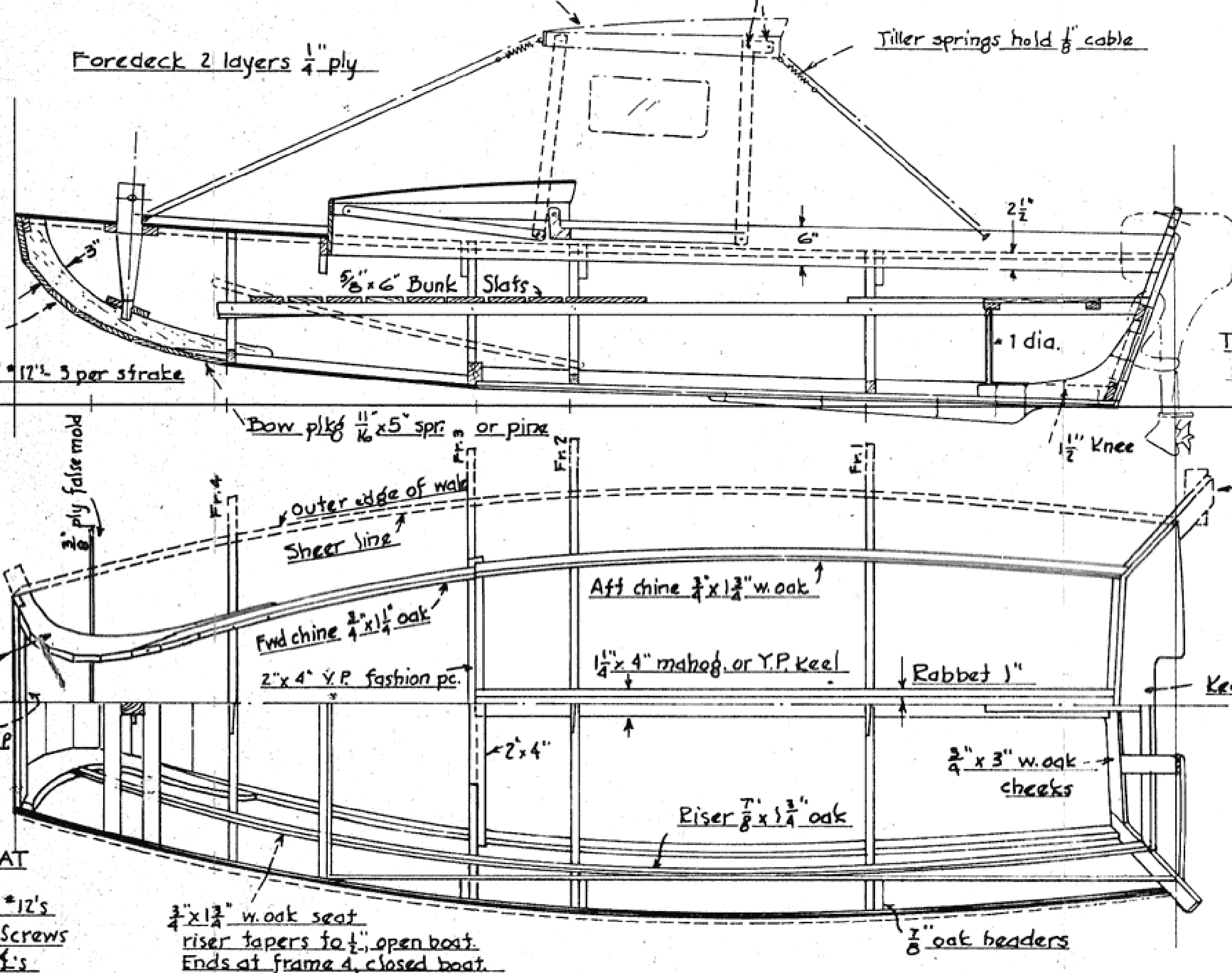

Frames are extended to stop floor on frame line, blocked & spiked securely

VIEW OF FRAME WORK SET UP ON SHOP FLOOR (looking downward)

Keel & chine do not go thru 3/4" 5ply transoms

SCHEME OF WALE, OPEN BOAT

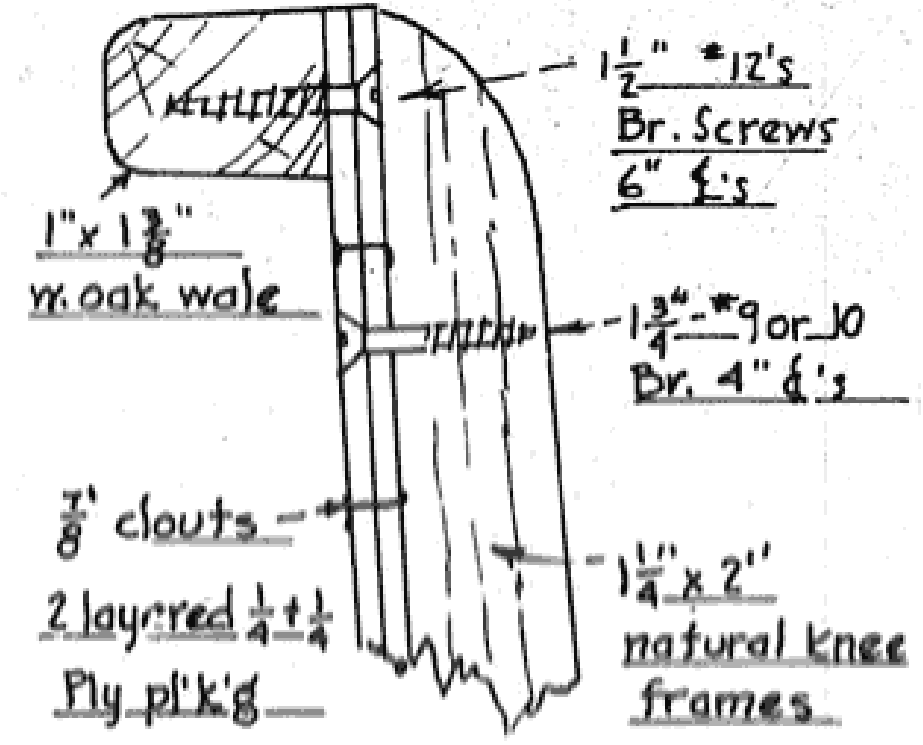

3/4 x 1 3/4 w. oak seat riser tapers to 1/2" open boat. Ends at frame 4, closed boat.

Scheme of how 2 x 4 fashion piece is cut for V & bow planes

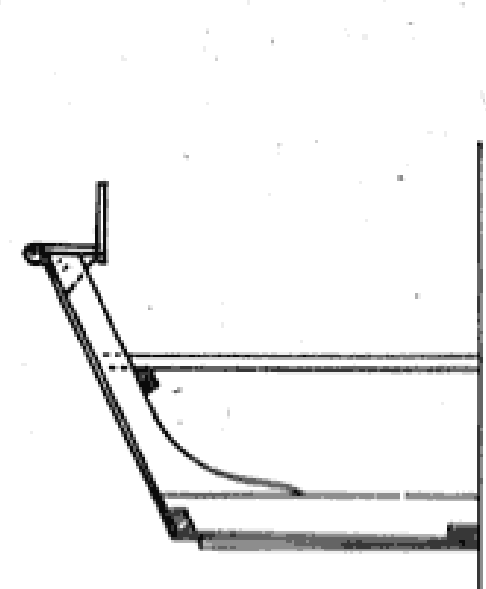
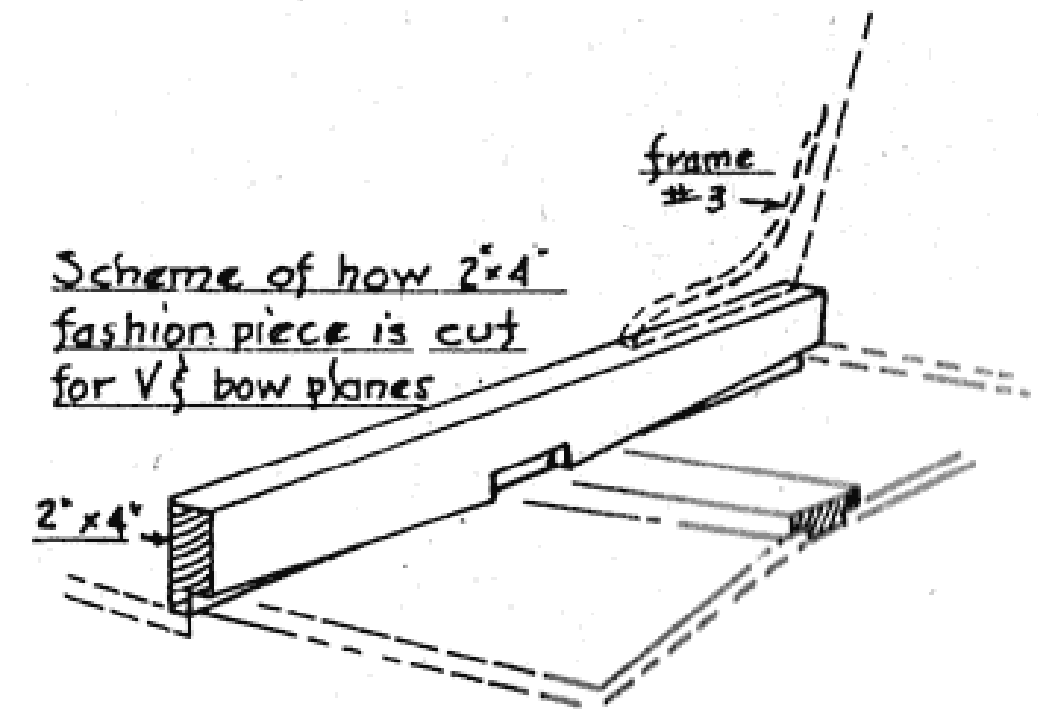

Section abaft frame 5 1' x 1/2" fwd

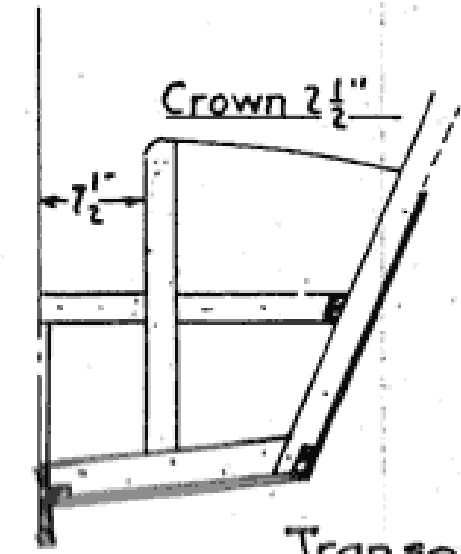

Transom Framing